

CARDIFF'S HOME FOR  
STYLISH SALES  
& LETTINGS

JeffreyRoss

CONNAUGHT ROAD  
ROATH





# CONNAUGHT ROAD

ROATH, CF24 3PX - £1,200 PCM PCM

2 bedroom(s) 1 bathroom(s) 478.00 sq ft

A ground-floor, two bedroom GARDEN flat on the popular, tree-lined Connaught Road. The property comes fully furnished with open-plan kitchen and living space, family bathroom and private courtyard garden. The master bedroom is of an extremely good size and the second bedroom is a fair size smaller, but would be a good second, single bedroom or office space. A nice flat.

EPC RATING of D  
COUNCIL TAX BAND of B.

A holding fee of one weeks' rent will be payable to secure the dwelling. This will be deducted from the final balance payable upon moving into the dwelling, subject to a successful application. Jeffrey Ross Limited reserves the right to retain this payment should the applicant have provided false or misleading information at the time of applying for the dwelling or failed to take reasonable steps to enter into the Standard Occupation Contract.

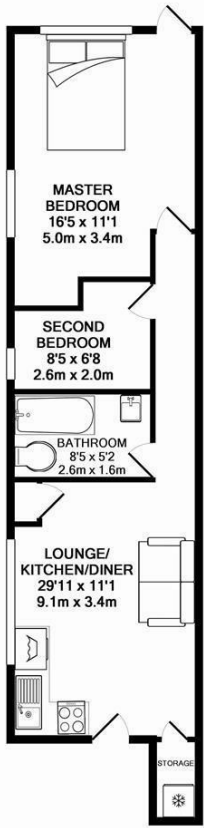

TOTAL APPROX. FLOOR AREA 478 SQ.FT. (44.4 SQ.M.)  
Whilst every attempt has been made to ensure the accuracy of the floor plan contained here, measurements of doors, windows, rooms and any other items are approximate and no responsibility is taken for any error, omission, or mis-statement. This plan is for illustrative purposes only and should be used as such by any prospective purchaser. The services, systems and appliances shown have not been tested and no guarantee as to their operability or efficiency can be given  
Made with Metropix 6/2015

Energy Efficiency Rating		
	Current	Potential
Very energy efficient - lower running costs		
(92 plus) A		
(81-91) B		
(69-80) C		
(55-68) D	66	74
(39-54) E		
(21-38) F		
(1-20) G		
Not energy efficient - higher running costs		
England & Wales	EU Directive 2002/91/EC	

PROPERTY SPECIALIST

Mr Rhys Carter  
rhys.carter@jeffreyross.co.uk



Lettings